

Throttle valve type MG

NS 6 - 30 | p_{max} 31,5 MPa | Q_{max} 400 dm³/min | WK 496 290



DATA SHEET - OPERATION MANUAL

APPLICATION

Throttle valves type MG... are used to throttle fluid flow which depends on a pressure difference at the throttle point and on viscosity of the fluid. They can be used in hydraulic systems where a constant working resistance occurs or change of speed under variable load is of no importance. The valves are suitable for mounting on pipelines in any position.

DESCRIPTION OF OPERATION

Fluid is provided through the side bores **1** in the body **2** to the throttle point **3** between the body and the adjustable sleeve **4**. Through rotation of the sleeve **4** one can steplessly change circular cross-section of the throttle point **3**. Throttle is performed in both directions of the flow.

Caution:

When installing the valve in a hydraulic system, hold the valve by its hexagonal body **2**. Do not tighten the valve by means of the sleeve **4**. **Do not adjust under pressure!**



MG6 G15

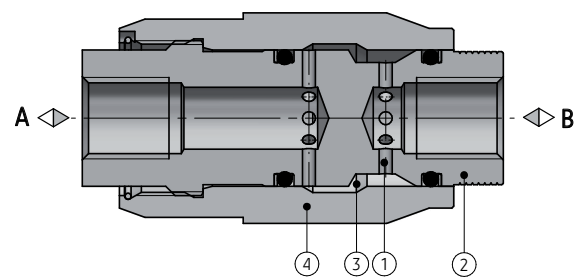

TECHNICAL PARAMETERS

hydraulic fluid	mineral oil
required filtration	up to 16 µm
recommended filtration	up to 10 µm
nominal viscosity of the fluid	37 mm ² /s at temp 55 °C
viscosity range	2,8 ÷ 380 mm ² /s
fluid temperature range (in tank)	max. -20 ÷ 70 °C; recommend 40÷55 °C
ambient temperature range	-20 ÷ 70 °C
maximum operating pressure	31,5 MPa
weight	0,30 ÷ 4,1 kg (details on page 2)

assembly and operation requirements at www.operating-conditions.ponar.pl

HYDRAULIC DIAGRAMS

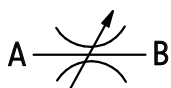

PERFORMANCE CURVES

measured at viscosity $\nu = 41 \text{ mm}^2/\text{s}$ and $t = 50 \text{ °C}$

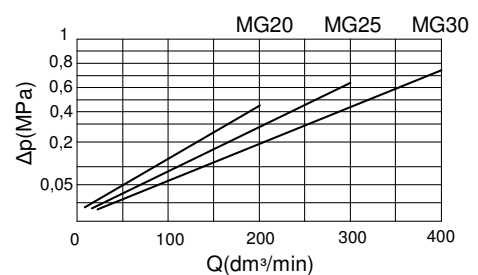
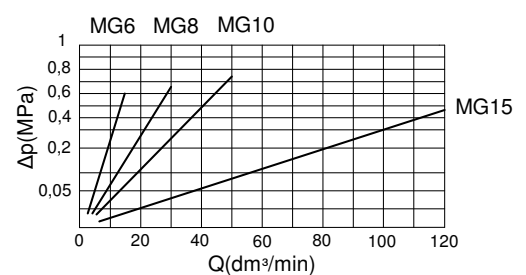

OVERALL DIMENSIONS

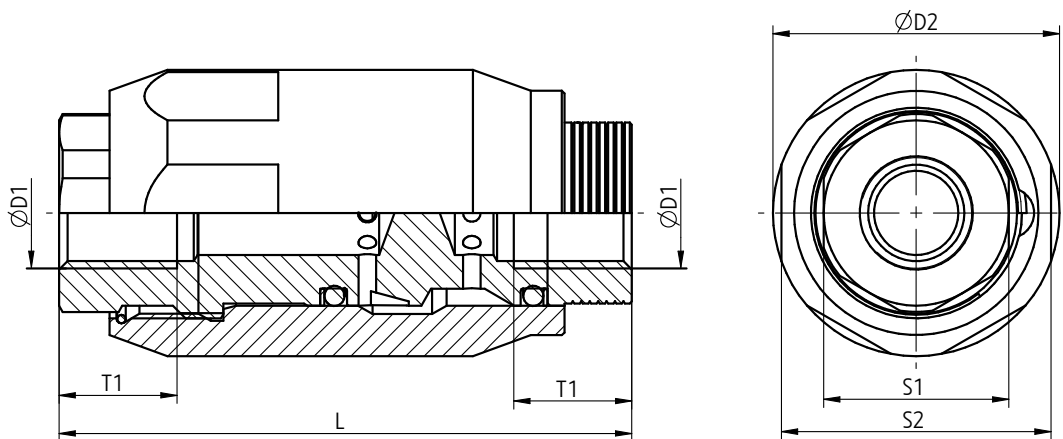

Size	ØD1	ØD2	L	S1	S2	T1	Weight (kg)
MG6...	G¼	34	68	22	32	14	0,3
MG8...	G¾	38	66	24	36	12,5	0,4
MG10...	G½	48	80	30	46	14	0,7
MG15...	G¾	58	97	36	55	16	1,1
MG20...	G1	72	113	46	70	18	1,9
MG25...	G1 ¼	87	129	55	85	20	3,2
MG30...	G1 ½	93	145	60	90	22	4,1

HOW TO ORDER

Orders coded in the way showed below should be forwarded to the manufacturer.

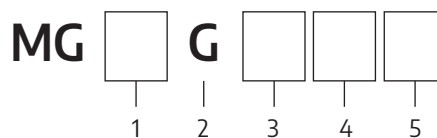

1 nominal size (NS)

WN6 =	6
WN8 =	8
WN10 =	10
WN15 =	15
WN20 =	20
WN25 =	25
WN30 =	30

2 mounting

Direct in-line mounting = G

3 series number

(10-19) - installation and connection dimensions remain unchanged = 1X
series 15 = 15

4 sealing

NBR (for fluids on mineral oil base) = Ø
FKM (for fluids on phosphate ester base) = V

5 further requirements = *

(to be agreed with the manufacturer)

Ø indicates that the box should be left blank

Coding example: MG 6 G 15

CONTACT

PONAR Wadowice S.A.
ul. Wojska Polskiego 29
34-100 Wadowice

phone +48 33 488 21 00
www.ponar-wadowice.pl